

DC044A

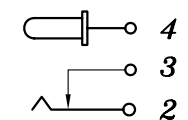

SCHEMATIC

PIN

Ø1.65

DC044A-2

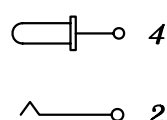

SCHEMATIC

Ø2

Ø2.5

APPD

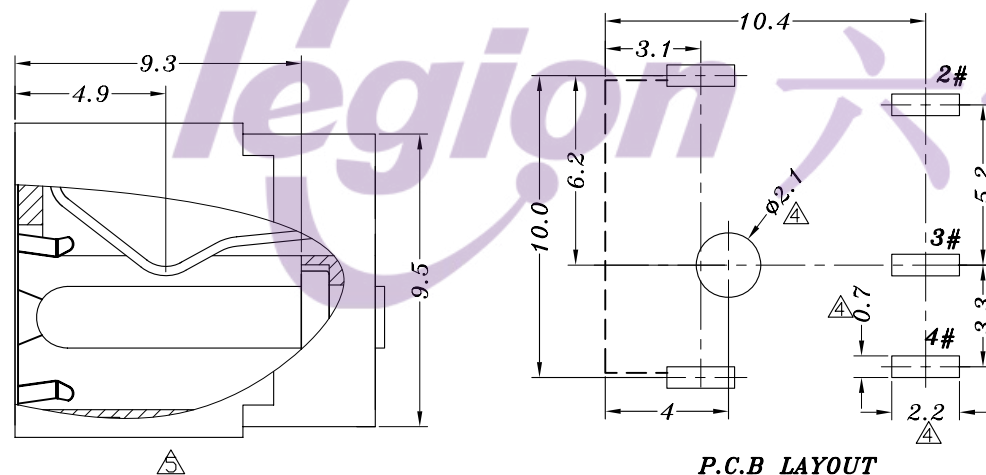

P.C.B LAYOUT

Specification:

1. Rating : DC 30V 0.5A.

2. Contact resistance: $\leq 70\text{m}\Omega$.3. Insulation resistance: $\geq 100\text{M}\Omega$ (250VDC).

4. Withstanding voltage: 250VAC.

5. Insertion and extraction force: 3N~30N.

6. life test: 5000cycles min.

7. Operation temperature range: $-25^{\circ}\text{C} \sim 70^{\circ}\text{C}$.

B1	2020.7.01	新增视图及产品技术规格	GYW	
A5	2019.8.30	新增产品局部剖视图	GYW	
A4	2018.12.24	新增PCB板开孔尺寸标注	GYW	
A3	2018.12.07	修改“h”“i”尺寸公差为 ± 0.2	GYW	
A2	2018.11.12	修改BOM信息: 改用DC044B前盖无镀	GYW	
A1	2018.4.13	盖脚尺寸9.8改为10.0	GYW	
A0	2013.8.29	初版	LIU	
NO	DATE	REVISIONS	BY	APPD

NO.	PART	NAME	MATERIAL	QTY	FINISHING	TOLERANCE UNLESS SPECIFIED	UP TO 5mm: ± 0.1 ABOVE 5mm: ± 0.2	ANGULAR $\pm 1^{\circ}$	TITLE: DC JACK MODEL: DC-044A 2.5-PU	UNIT : MM SCALE: 5:1	ROHS COMPLIANT	DWN CHK'D	APPD	PRO.AGL:	REV :B1
7	DC044	PING	BRASS	1	Ni PLATED										
6	DC044A	COAT	SUS	1	Ni PLATED										
5	DC044B	COVER	SUS	1	WASH										
4	DC044	2#SPRING	SUS/PBS	1	Ag PLATED										
3	DC044	3#CURVE PIECE	BRASS	1	Ag PLATED										
2	DC044	4#FLAT PIECE	BRASS	1	Ag PLATED										
1	DC044A	CASE	PBT/PA9T	1	BLACK										

东莞市六钧电子五金有限公司